

Wi-Fi module, I/O cover and motherboard mounting guide

Step1: Install the Wi-Fi/Bluetooth module and then secure it with the bundled screw from bottom.

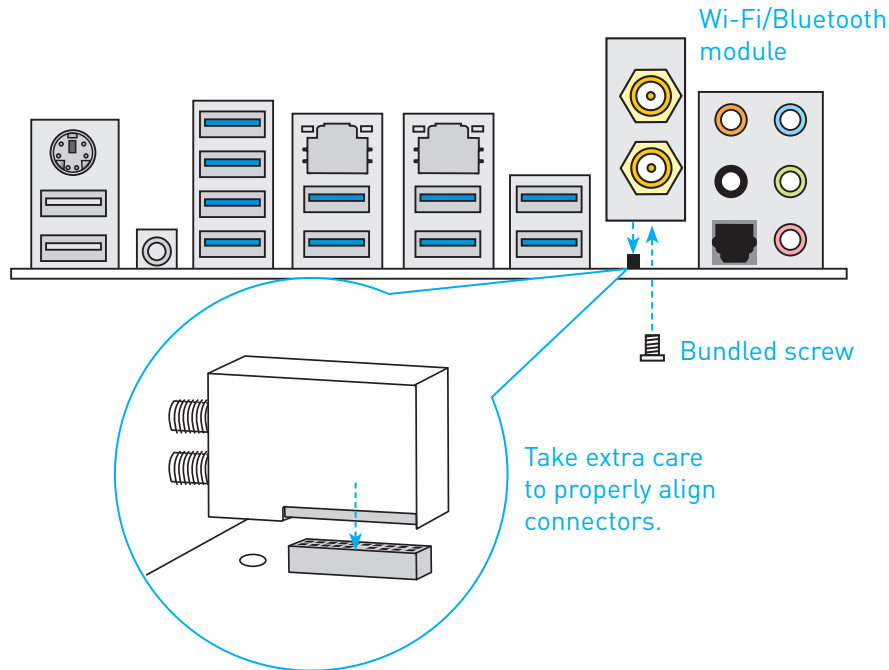

Step2: Align the two holes of the I/O cover with the two holes beside the rear I/O of the motherboard.

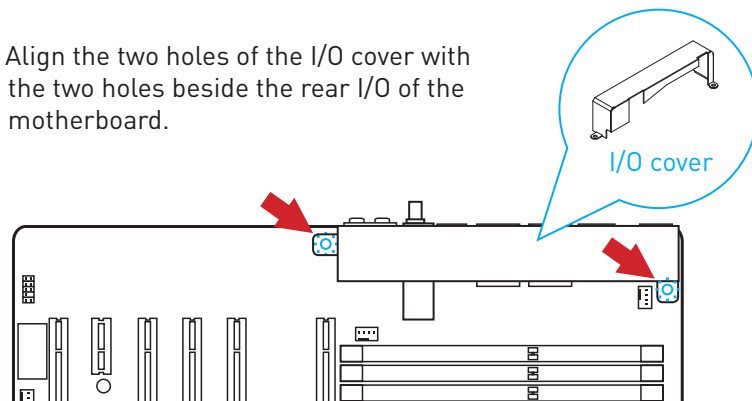

Step3: Use the screws to secure the motherboard and the I/O cover to the case.

